

# Outdoor Shower

## *Installation Guide*

# Outdoor Shower Installation Guide

## Contents

Important Information	3
In the box	4
Installation	5

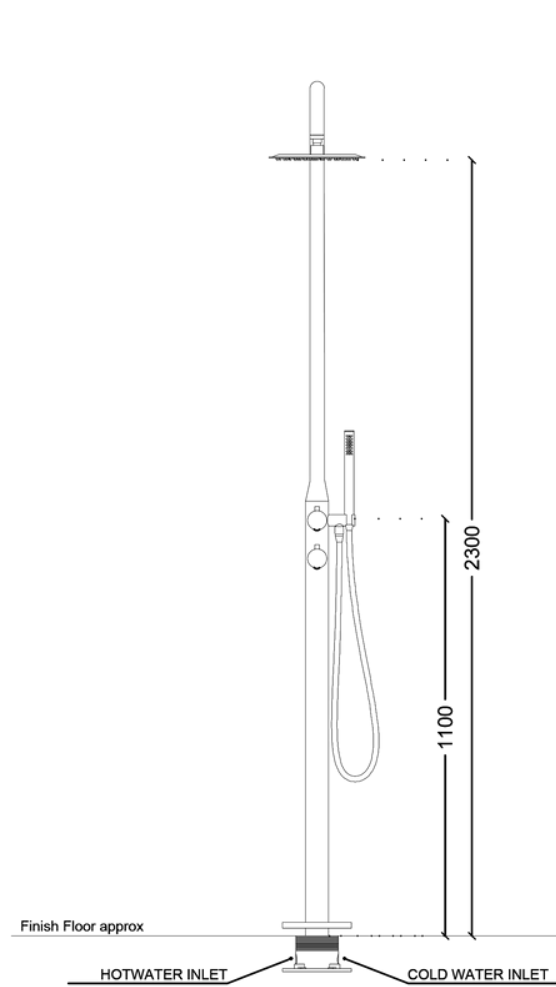

FRONT VIEW

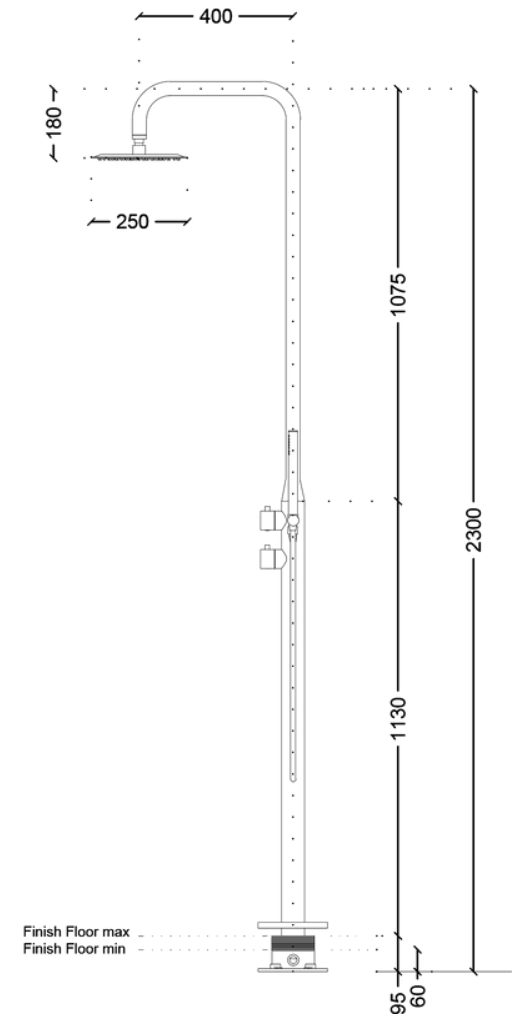

SIDE VIEW

# Important Information



1. LINSOL's Outdoor shower must be installed by a licensed plumber in accordance with AS/NZ 3500.
2. Outdoor Showers not installed by a licensed plumber will not be covered by any warranty.
3. Any LINSOL Outdoor Shower installed incorrectly, including the use of any type of concrete encasing at the base will not be covered by any warranty.
4. Please note drainage is not pictured within this installation guide.
5. Please ensure your drainage is in accordance with your local standards.

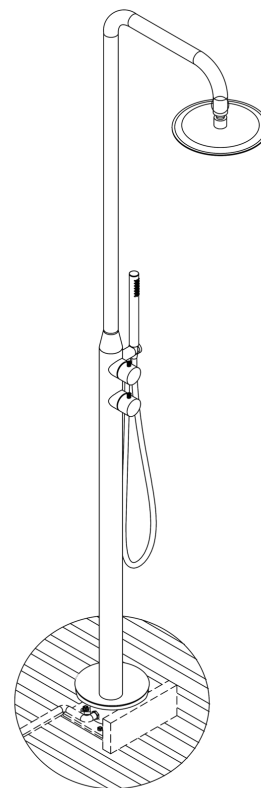

Installation on top of concrete slab with timber decking.

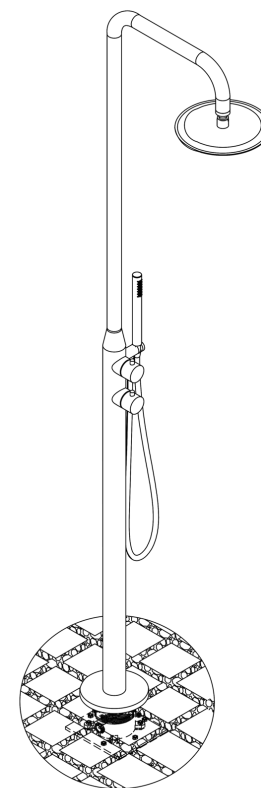

Installation on top of concrete slab with fine stone fill, decorative stone and removable paving.

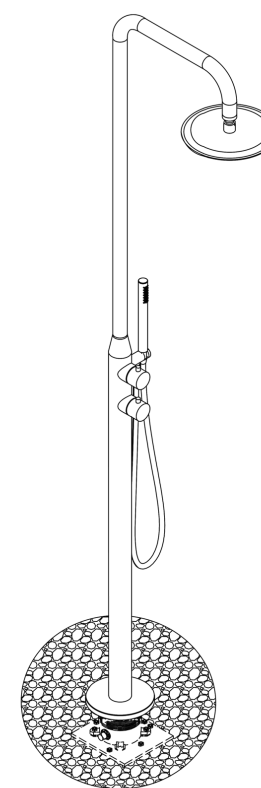

Installation on top of concrete slab with fine stone fill and decorative stone.

# In The Box



- |                 |                                  |
|-----------------|----------------------------------|
| 1. Base         | 8. Hand Shower                   |
| 2. Fixing Plate | 9. Hose                          |
| 3. Cover Plate  | 10. 4 x Sleeve Anchors           |
| 4. Post         | 11. 4 x Bolt & Washers           |
| 5. Mixer body   | 12. 2 x Inlet Blockers & Washers |
| 6. Arm          | 13. Pex Hoses & Rubber O-Rings   |
| 7. Shower Head  |                                  |

## Caring for your Outdoor Shower



Clean your outdoor shower regularly using mild soap and water.



NEVER Use abrasive cleaners like bleach or cream cleaners



NEVER use scrub brushes or abrasive pads as these may scratch the material.

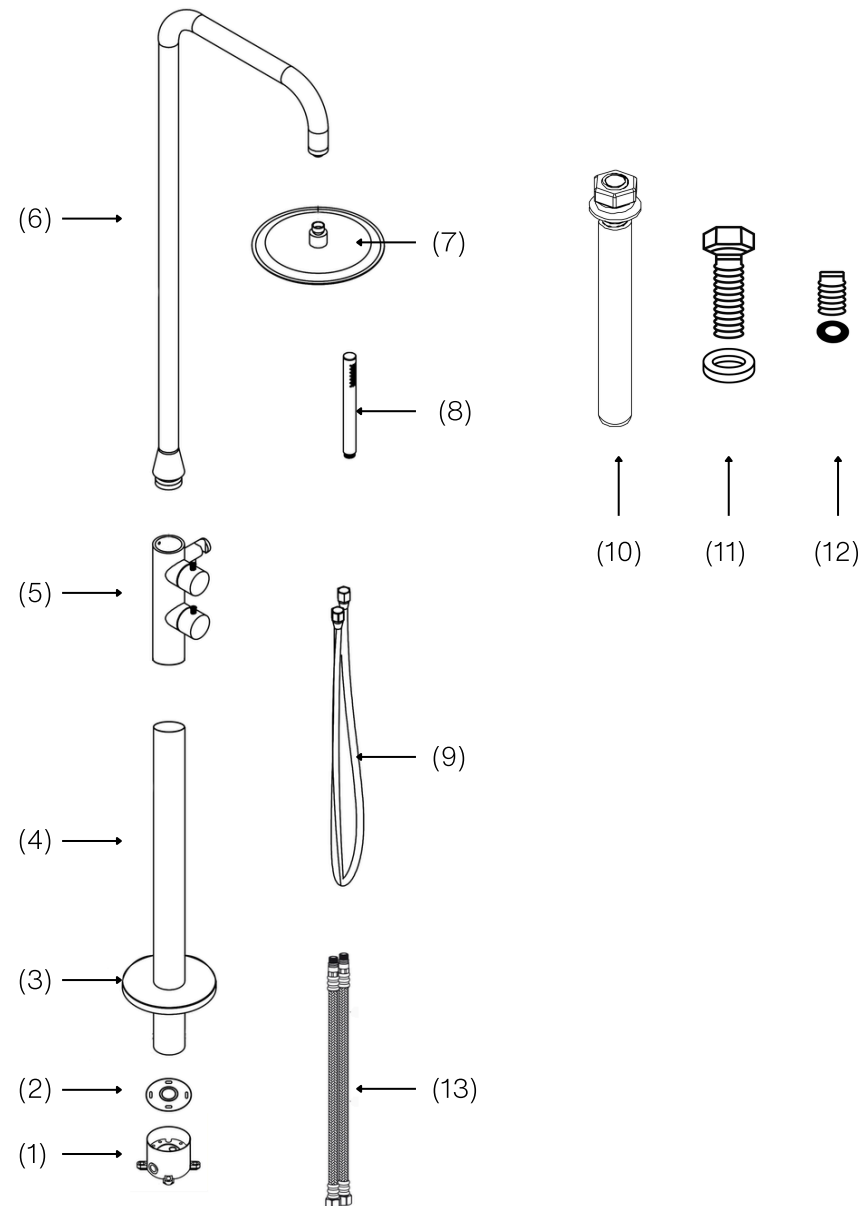

# Installation

## Base Connection

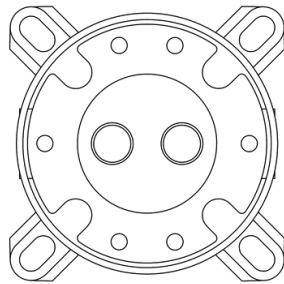

TOP VIEW

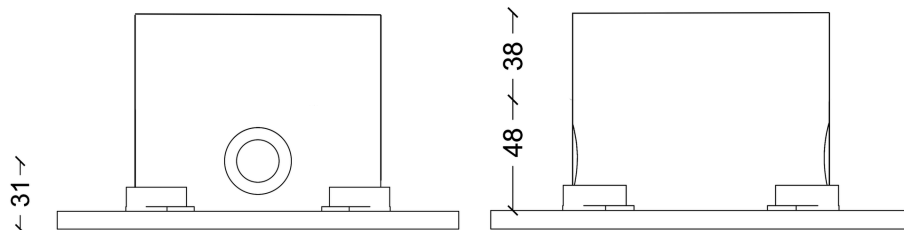

SIDE VIEW

FRONT VIEW

## Step 1.

- (1) Attach the PEX Hoses to the Mixer Body. Assemble the mixer body onto the post, then slide the cover plate over the post. Secure fixing plate to underside of the post.  
Tighten both the mixer body and the fixing plate as firmly as possible to minimise any unnecessary movement in the shower column.
- (2) For best results, secure the unit to a solid surface and hand tighten as much as possible

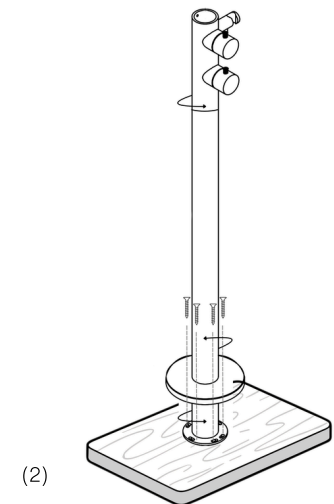
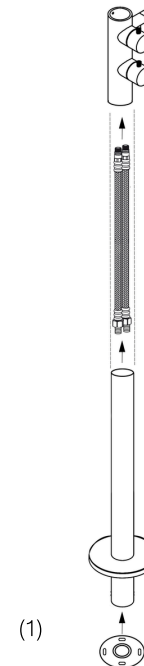

# Installation

## Step 2.

Use the partially assembled shower column and the base plate to align the desired position of the unit. Mark holes ensuring you are happy with the total positioning of the unit, as there is only a small amount of adjustment after the unit is installed.

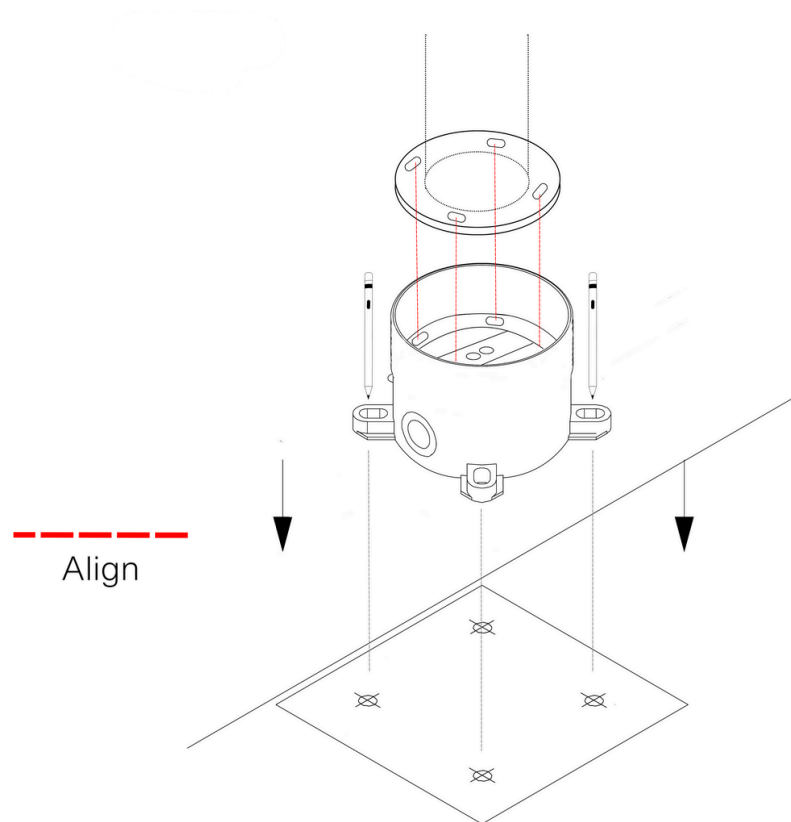

## Step 3.

- (1) Remove the base plate and drill holes into concrete.
- (2) Insert sleeve anchors.

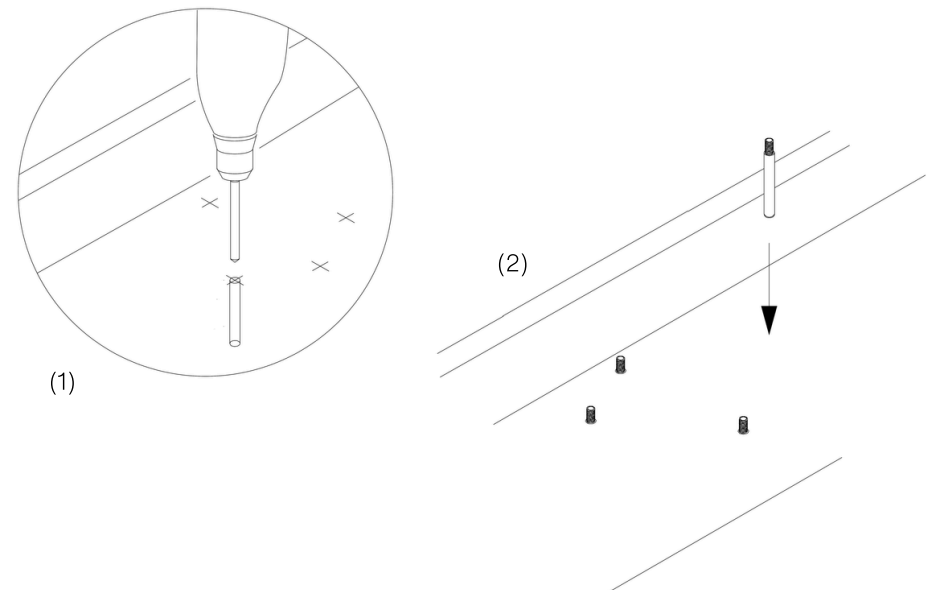

# Installation

## Step 4.

- (1) Secure base by tightening nuts.
- (2) Using appropriate thread sealant, attach hot and cold water pipes.
- (3) Fit blocking plugs.

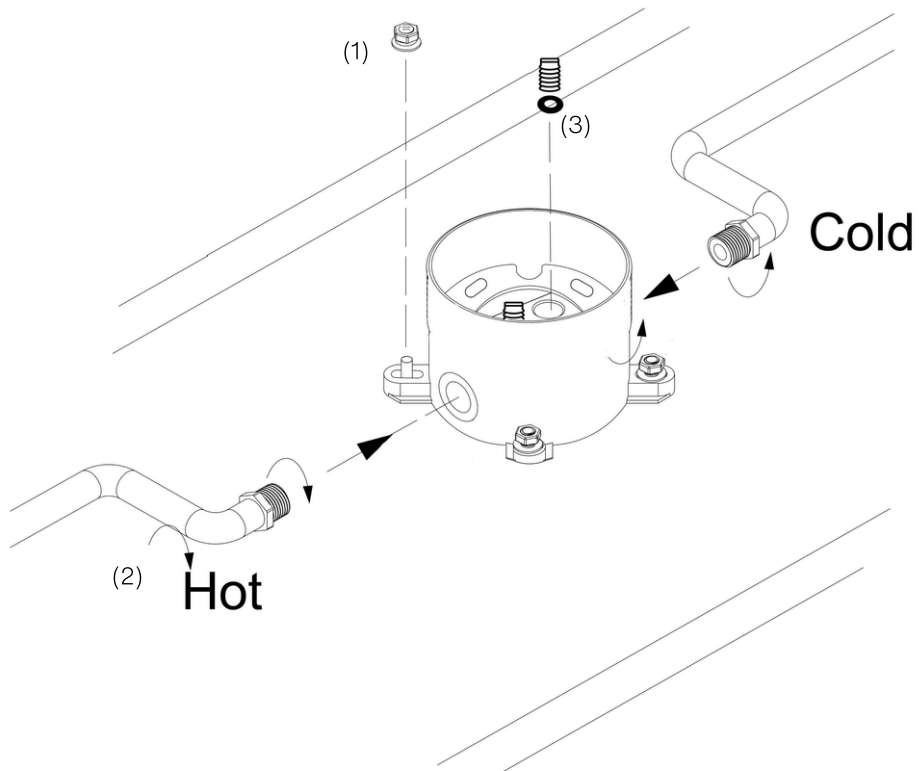

## Step 5.

Secure the Water pipes.

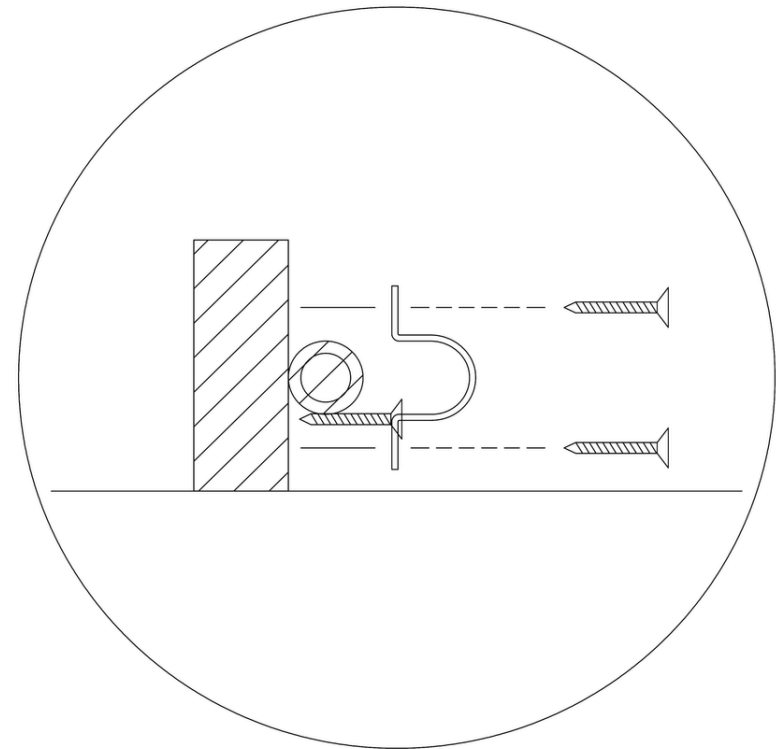

# Installation

## Step 6.

- (1) Remove the blocking plugs.
- (2) Attach the body & PEX hoses to the base plate. Ensure you use O-rings supplied.

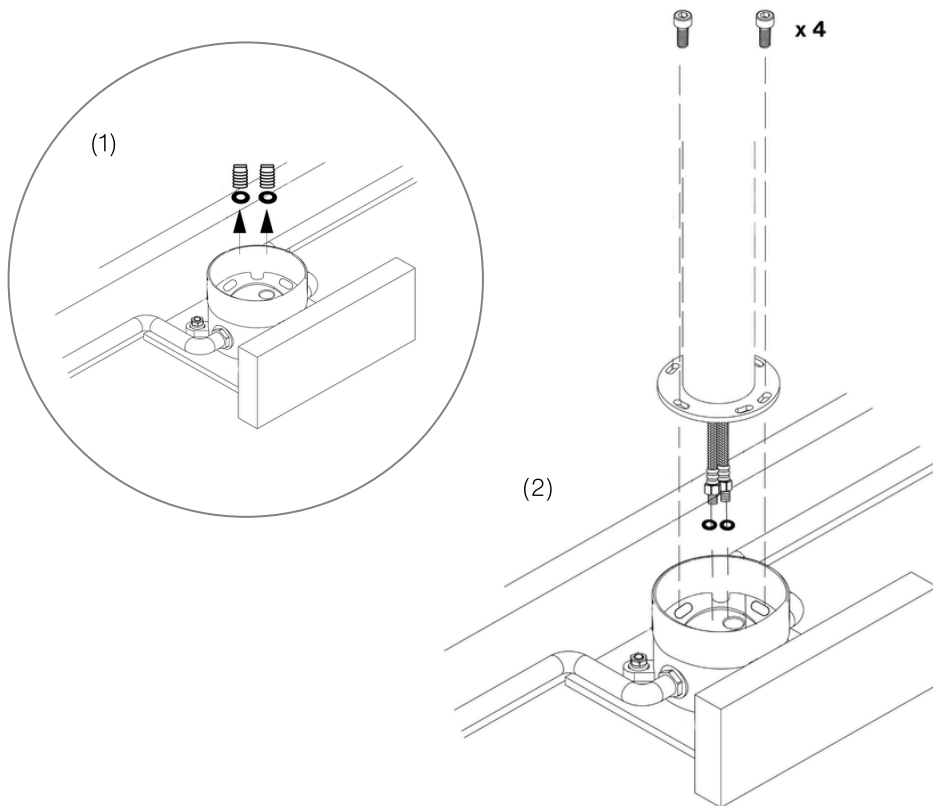

## Step 7.

Connect the shower head to the arm.

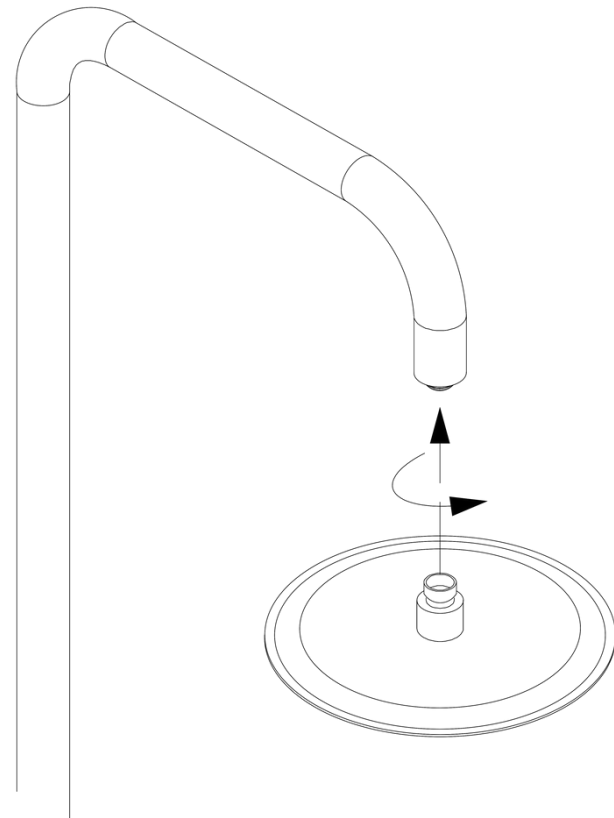



# Installation

## Step 8.

### Connect Arm to Body

- (1) Connect the internal flexi-hoses.
- (2) Push arm & body together and fasten with Allen Key.
- (2) Ensure water connection is adequate and there are no leaks.

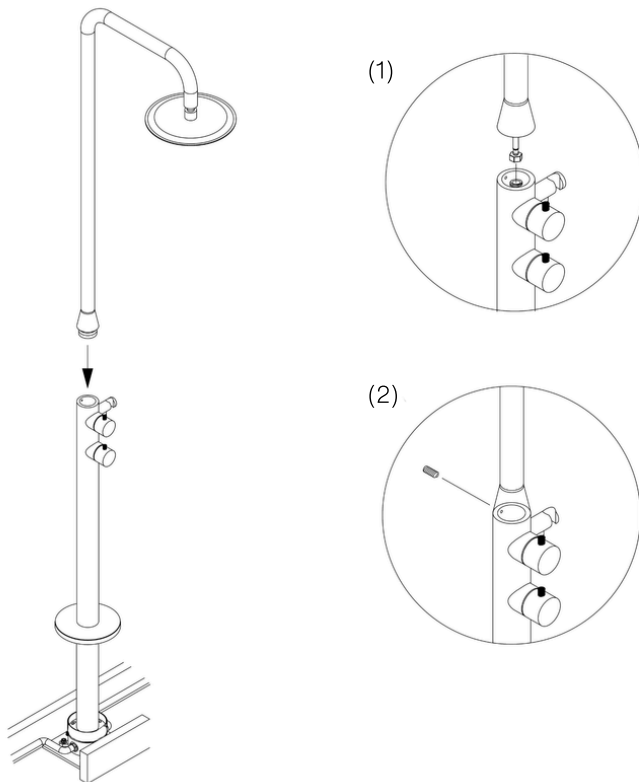

## Step 9.

Assemble Hand Shower & Hose.

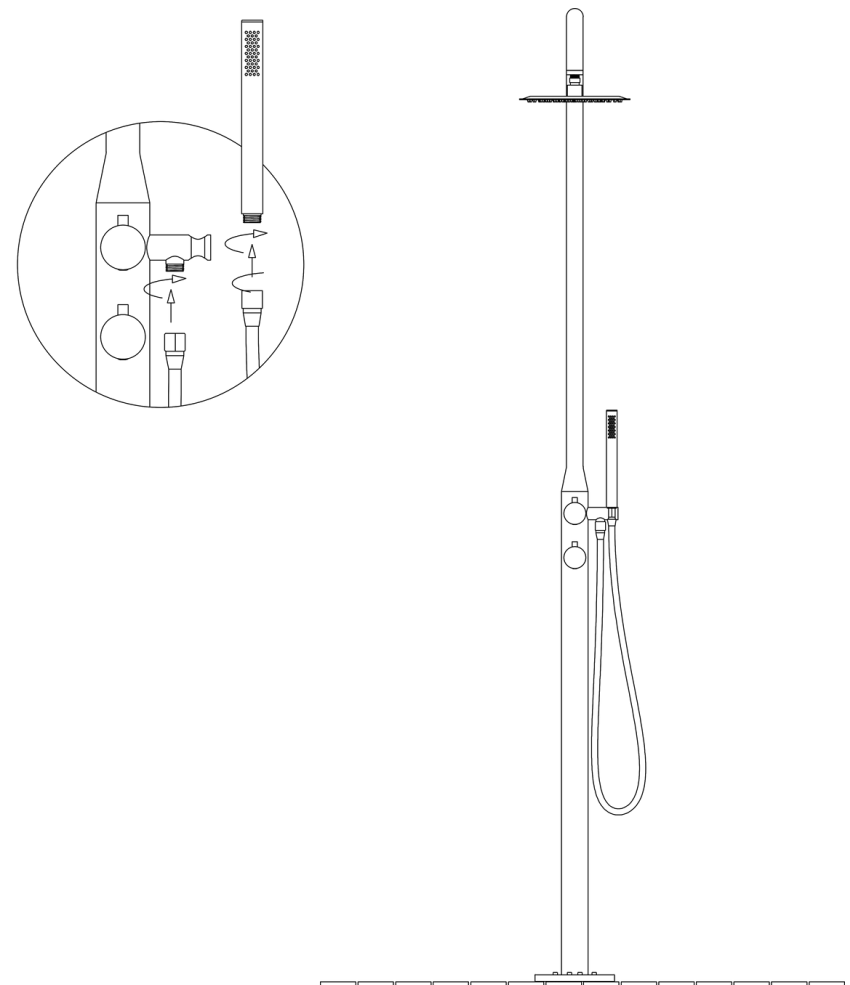

# Installation



## Step 10.

Slide the coverplate down over base.

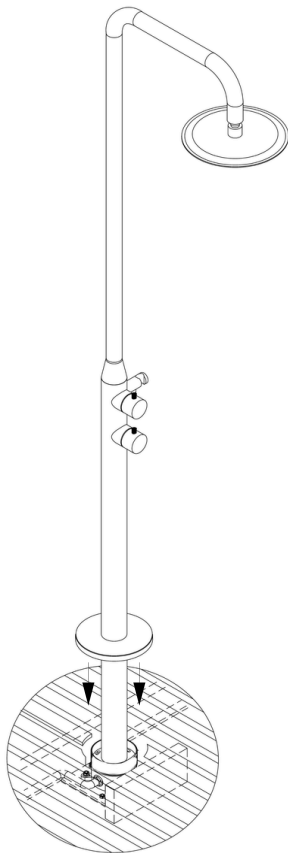

## Complete

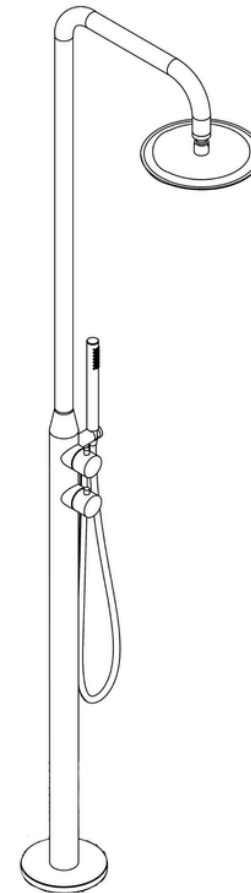



Experience, *the difference.*