

# Heritage Shaker 750mm Wall Hung Vanity

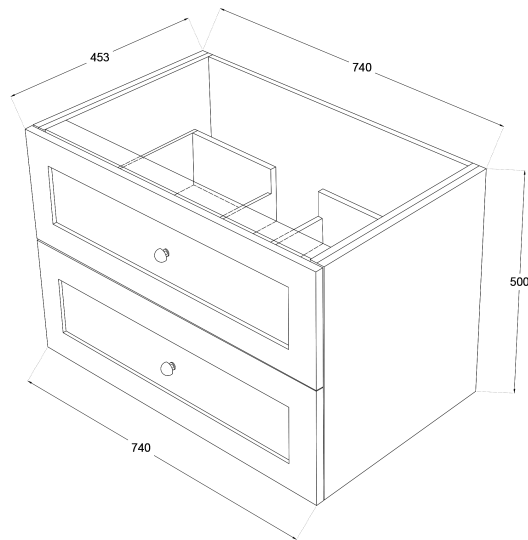

TOP VIEW: DRAWERS

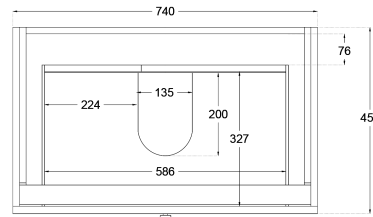

SIDE VIEW:  
DRAWER STORAGE

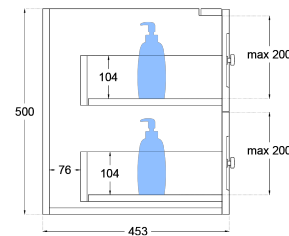



## Product Specifications

**Code:** HER-750-2DRW-GS  
**Finish:** Sage Green  
**Primary Material:** White Melamine  
**Technical Features:** Drawers: 2  
 Mounting: Wall Hung  
 Included: Single Bowl Vanity Stone  
 Double Carcass  
 Standard White Stone  
**Special Features:** Soft Close  
 Hand Made

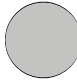

- 

**HER-750-2DRW-TR**  
Tranquil Retreat  
Polyurethane Spray Paint
- 

**HER-750-2DRW-GS**  
Sage Green  
Polyurethane Spray Paint
- 

**HER-750-2DRW-FN**  
French Navy  
Polyurethane Spray Paint
- 

**HER-750-2DRW-MB**  
Matte Black  
Polyurethane Spray Paint
- 

**HER-750-2DRW-SW**  
Satin White  
Polyurethane Spray Paint

Experience, *the difference.*



LINSOL.COM.AU

☎ 1300 546 765

@ info@linsol.com.au

✉ PO Box 88, Coniston NSW 2500

All information is correct at time of writing. The actual product may vary slightly and sizes may be scaled up or down. Warranty is for domestic use only. For warranty & care information please visit [linsol.com.au/warranty](http://linsol.com.au/warranty)